

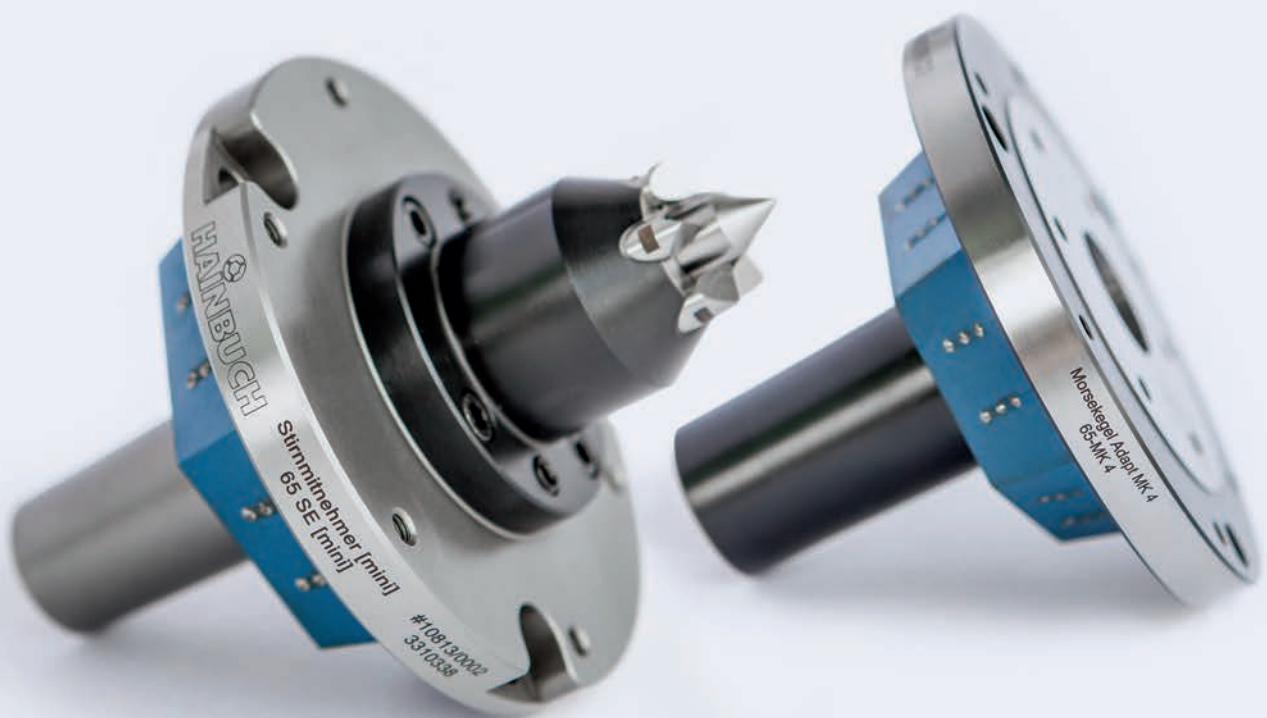

# Face driver / morse taper adaptation





Be flexible and machine your workpiece over its entire length between centers with the face driver adaptation. First, this increases run-out precision. Secondly, it shapes and positions tolerances better, and thirdly, it speeds up mounting of the face driver adaptation.

The morse taper adaptation gives you even more flexibility. Whether face driver, fixed center, a manually activated mandrel, or even tools – with this adaptation you can use anything that you can adapt with the morse taper connection. Therefore, you have the possibility of extending your chuck with many additional functions within seconds.

This is made possible by the CENTREX quick change-over interface integrated in both adaptations. This enables mounting of the adaptation without the need for alignment.

#### Key advantages

- Tremendous flexibility
- Self-centering of the adaptation in the chuck without alignment
- Extremely fast conversion without disassembling the chuck [1 min.]

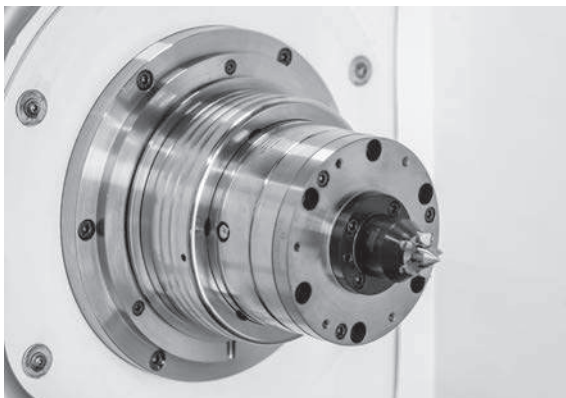

Face driver adaption on the machine

## ADAPTATION CLAMPING DEVICES

### Face driver / morse taper adaptation



#### Face driver / morse taper

	Face driver adaptation	Morse taper adaptation
		
Description	Adaptation for clamping between centers	Adaptation to the MK4 reception
Sizes	42, 52, 65, 80, 100	42, 52, 65, 80, 100
Clamping range of all sizes [mm]	–	–
Variant	SE [hexagonal], RD [round]	SE [hexagonal], RD [round]
<b>Advantages</b>	<ul style="list-style-type: none"> <li>■ Spring-loaded center</li> <li>■ Hard metal face driver</li> <li>■ Assembly in 1 minute without alignment</li> </ul>	<ul style="list-style-type: none"> <li>■ Adaptation possibility via morse taper</li> <li>■ Assembly in 1 minute without alignment</li> <li>■ Self-centering of the adaptation in the chuck without alignment</li> </ul>

#### Face driver SE in detail

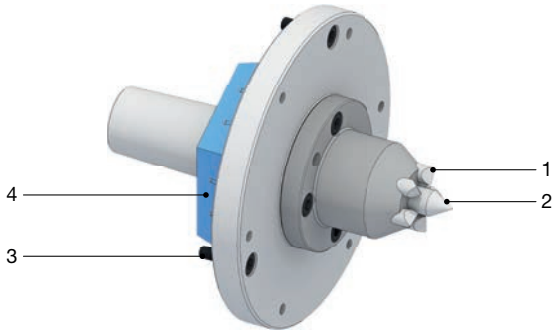
Designation	
<ol style="list-style-type: none"> <li>1 Hard metal face driver</li> <li>2 Spring-loaded center</li> <li>3 Mounting screws</li> <li>4 CENTREX system for <math>\mu\text{m}</math>-precise use without adjustment</li> </ol>	

#### Morse taper adaptation SE in detail

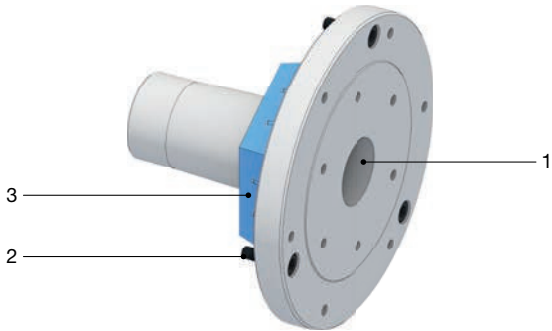
Designation	
<ol style="list-style-type: none"> <li>1 Morse taper size 4</li> <li>2 Mounting screws</li> <li>3 CENTREX system for <math>\mu\text{m}</math>-precise use without adjustment</li> </ol>	



# ADAPTATION CLAMPING DEVICES

## Face driver / morse taper adaptation

### Face driver adaptation SE. Technical data and order overview

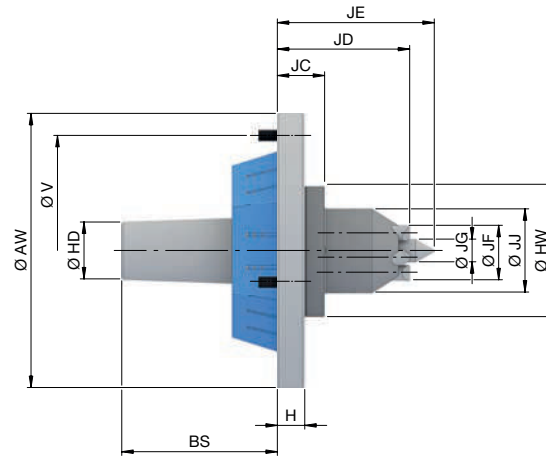

Product line	SE						
Size	52		65		100		
Suitable for	TOPlus mini / premium	all except TOPlus mini / premium	TOPlus mini / premium	all except TOPlus mini / premium	TOPlus mini / premium	all except TOPlus mini / premium	
Run-out ≤ [mm]			0,010				
RPM n max. [1/min.]	7000		6000		5000		
Length [mm]	H			14,5			
Length 2 [mm]	BS	69,3		82,3		83,3	
Length 3 [mm]	JC			25			
Length 4 [mm]	JD	56		70		81,5	
Length 5 [mm]	JE	63,5		83		101	
Outer Ø [mm]	AW	119	125	129	145	183	215
Outer Ø 2 [mm]	HD			30			
Outer Ø 3 [mm]	HW	52		70		86	
Outer Ø 4 [mm]	JJ	29		44		60	
Driving pin-Ø	JF	20		31		45	
Center-Ø	JG	6		12		20	
Bolt hole circle	V	LK Ø 105 [3 x M8]	LK Ø 107 [3 x M6]	LK Ø 112 [3 x M8]	LK Ø 126 [3 x M6]	LK Ø 160 [3 x M8]	LK Ø 180 [3 x M8]
Weight [kg]		2,3		3,6		7,7	
In stock		-	✓	✓	✓	-	✓
Material no.		10000993	10000603	10000994	10000604	10000995	10000605

Mounting precision for rotating clamping devices: Run-out ≤ 0.005 mm between chuck and adaptation clamping device. Run-out errors on the chuck must also be taken into consideration. Mounting repeatability for stationary clamping devices: ≤ 0.003 mm on the adaptation clamping device.

# ADAPTATION CLAMPING DEVICES

## Face driver / morse taper adaptation



### Morse taper adaptation [MK4] SE. Technical data and order overview

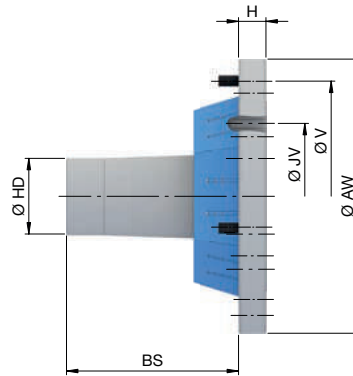

Product line		SE					
Size		52		65		100	
Suitable for		TOPlus mini / premium	all except TOPlus mini / premium	TOPlus mini / premium	all except TOPlus mini / premium	TOPlus mini / premium	all except TOPlus mini / premium
Run-out ≤ [mm]		0,010					
RPM n max. [1/min.]		7000		6000		5000	
Length [mm]	H	14,5					
Length 2 [mm]	BS	91					
Outer Ø [mm]	AW	119	125	129	145	183	215
Outer Ø 2 [mm]	HD	40					
Bolt hole circle	V	LK Ø 105 [3 x M8]	LK Ø 107 [3 x M6]	LK Ø 112 [3 x M8]	LK Ø 126 [3 x M6]	LK Ø 160 [3 x M8]	LK Ø 180 [3 x M8]
Bolt hole circle 2	JV	LK Ø 60 [6 x M6]		LK Ø 77 [6 x M6]		LK Ø 80 [6 x M6]	
Weight [kg]		2		2,8		6	
In stock		-	✓	✓	✓	-	✓
Material no.		10000996	10000614	10000997	10000615	10000998	10000616

Mounting precision for rotating clamping devices: Run-out ≤ 0.005 mm between chuck and adaptation clamping device. Run-out errors on the chuck must also be taken into consideration. Mounting repeatability for stationary clamping devices: ≤ 0.003 mm on the adaptation clamping device.



# ADAPTATION CLAMPING DEVICES

## Face driver / morse taper adaptation

### Face driver adaptation RD. Technical data and order overview

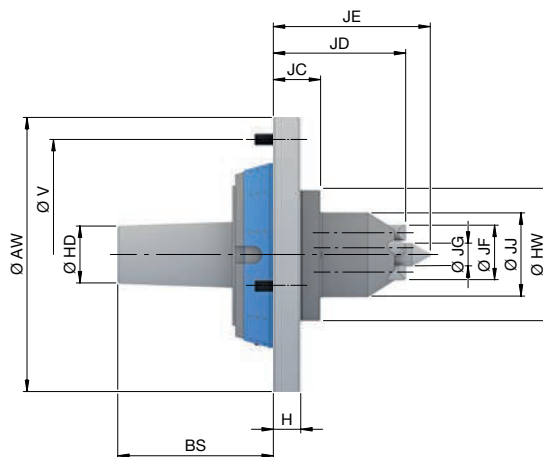

Product line	RD			
Size	42/52	65	80	100
Run-out ≤ [mm]	0,010			
RPM n max. [1/min.]	7000	6000	5500	5000
Length [mm]	H	14,5		
Length 2 [mm]	BS	69,3	83,3	
Length 3 [mm]	JC	82,3	25	
Length 4 [mm]	JD	56	81,5	
Length 5 [mm]	JE	63,5	101	
Outer Ø [mm]	AW	125	160	215
Outer Ø 2 [mm]	HD	30		
Outer Ø 3 [mm]	HW	52	86	
Outer Ø 4 [mm]	JJ	29	60	
Driving pin-Ø	JF	20	45	
Center-Ø	JG	6	20	
Bolt hole circle	V	LK Ø 107 [3 x M6]	LK Ø 126 [3 x M6]	LK Ø 139 [3 x M6]
Weight [kg]		2,4	3,4	4,6
In stock		✓	✓	✓
Material no.	10000606	10000608	10000609	10000610

Mounting precision for rotating clamping devices: Run-out ≤ 0.005 mm between chuck and adaptation clamping device. Run-out errors on the chuck must also be taken into consideration. Mounting repeatability for stationary clamping devices: ≤ 0.003 mm on the adaptation clamping device.



# ADAPTATION CLAMPING DEVICES

## Face driver / morse taper adaptation



### Morse taper adaptation [MK4] RD. Technical data and order overview

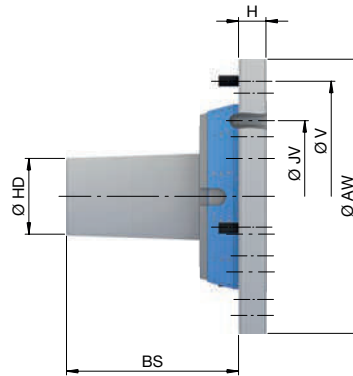

Product line	RD			
Size	42/52	65	80	100
Run-out ≤ [mm]	0,010			
RPM n max. [1/min.]	7000	6000	5500	5000
Length [mm]	14,5			
Length 2 [mm]	91			
Outer Ø [mm]	125	145	160	215
Outer Ø 2 [mm]	40			
Bolt hole circle	V LK Ø 107 [3 x M6]	LK Ø 126 [3 x M6]	LK Ø 139 [3 x M6]	LK Ø 180 [3 x M8]
Bolt hole circle 2	JV LK Ø 60 [6 x M6]	LK Ø 80 [6 x M6]		
Weight [kg]	2	2,7	3,5	5,7
In stock	✓	✓	✓	✓
Material no.	10000617	10000618	10000619	10000620

Mounting precision for rotating clamping devices: Run-out ≤ 0.005 mm between chuck and adaptation clamping device. Run-out errors on the chuck must also be taken into consideration. Mounting repeatability for stationary clamping devices: ≤ 0.003 mm on the adaptation clamping device.

